

Data Sheet

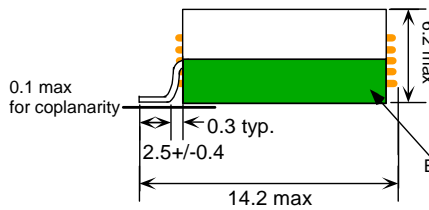

ICE Components, Inc.
 Helping Engineer the Technology of Power
 Tel 886-2-2971-1173 Fax 886-2-2986-7761
 E-mail:engineer@ica.com.tw
 www.icecomponents.com
 6-1Fl., No. 111, Sec. 3, Chung-Hsin Road,
 San-Chung City, Taipei Hsien, Taiwan

Mechanical Drawing

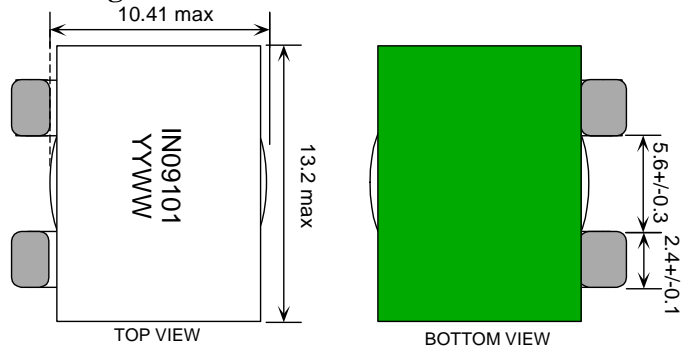

Note:
 Placed epoxy coating
 on the surface of bottom core.
 (Please refer to remark 6,7).

Epoxy coating with Green color

unit:mm

General Information

Customer	
Part Number	IN09101
Revision	0
Description	Inductor
Date	APR-26-2011
Reference	--
Doc Control #	--
Issue (For ICE use only)	--

Specification

Sample Test Data

Item	Pins	Spec	Test Condition	
Inductance	S – F	1.0 uH +/- 20%	100 kHz, 0.1 Vrms, series	
DCR	S – F	1.5 mOhm max	25 deg C	
Isat	S – F	60A max		

Schematic

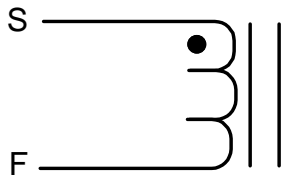

Recommended PCB Layout

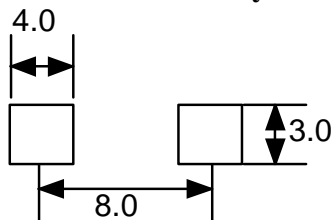

unit:mm

Remark

1. Isat is the current at which the inductance drops by 30% typical.
2. Meets UL94V-0
3. This is RoHS compliant product.
4. Inductance vs. Current Curve as attached.
5. The max operating temperature is 150degC (ambient + temperature rise).
6. The thickness of coating: 0.05mm min.
7. The part needs to be checked without scratch and core exposure.

Sample approval is required before release to production. Sample specifications take precedence over customer specifications.

Customer Signature

Rev.	Description	PRD	CHK	APP	Date	NTFY
0	Initial release	Emily	Gary	L. L. Chou	2011/4/26	2015/9/10

P/N: IN09101

