

Data Sheet



Helping Engineer the Technology of Power

ICE Components, Inc.

Tel 678-560-9172 Fax 678-560-9304

cust.serv@icecomp.com

www.icecomponents.com

1165 Allgood Rd., Ste. #20, Marietta, GA 30062

General Information

Customer	
Part Number	IN10114
Revision	0
Description	Inductor
Date	MAY-03-2011
Reference	--
Doc Control #	--
Issue (For ICE use only)	--

Mechanical Drawing

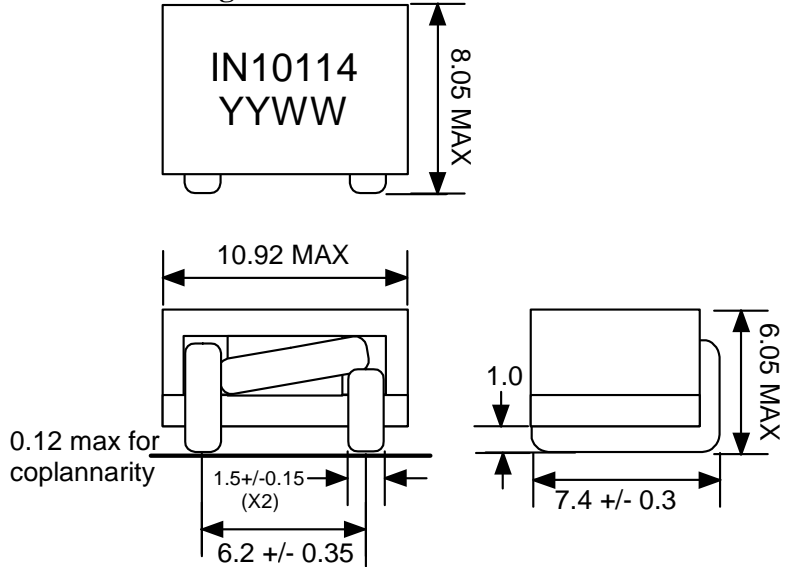

unit:mm

Specification

Sample Test Data

Item	Pins	Spec	Test Condition	Sample Test Data
Inductance @0Adc	S - F	240 nH +/- 15%	1 MHz, 0.1Vrms, series	
Inductance @Isat at 25degC	S - F	163 nH min	1 MHz, 0.1Vrms, series (42Adc)	
DCR	S - F	0.55 mOhms +/- 10%	+25 deg C	
Isat at 25degC	S - F	42 Adc		
Isat at +125degC	S - F	35 Adc		
Idc	S - F	38 Adc		

Schematic

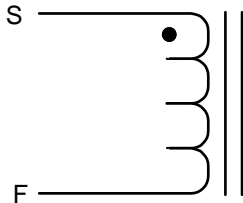

Recommended PCB Layout

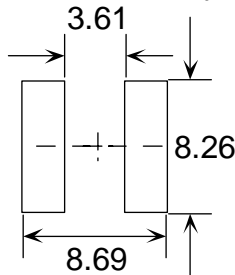

unit:mm

Remark

1. Isat is the current at which the inductance drops by 20%.
2. Inductance vs. Current Curve and Temperature vs. Current Curve as attached.
3. This is RoHS compliant product.
4. The max operating temperature is 130degC (ambient + temperature rise).

Sample approval is required before release to production. Sample specifications take precedence over customer specifications.

Customer Signature

Rev.	Description	PRD	CHK	APP	Date	NTFY
0	Initial release	Emily	Gary	L. L. Chou	2011/5/3	2011/5/3

P/N: IN10114

